

# Instruction Manual

## Munters Insulated Sidewall Inlet

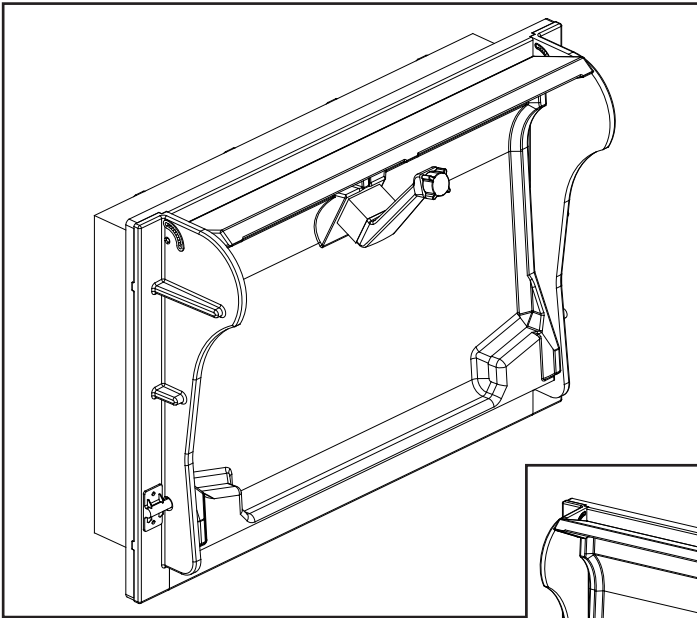

RV-ZEWP2900-AO

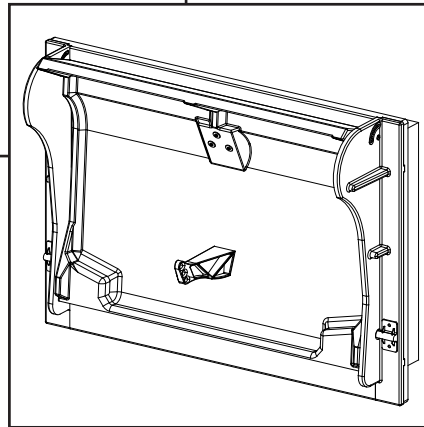

RV-ZEWP2900-AC

## Insulated Sidewall Inlet

Models: RV-ZEWP2900-AO • RV-ZEWP2900-AC



# Insulated Sidewall Inlet

## Instructions for Use and Maintenance

### Thank You:

Thank you for purchasing a Munters Insulated Sidewall Inlet. Munters equipment is designed to be the highest performing, highest quality equipment you can buy. With the proper installation and maintenance it will provide many years of service.

### Please Note:

To achieve maximum performance and insure long life from your Munters product it is essential that it be installed and maintained properly. Please read all instructions carefully before beginning installation.

### Warranty:

For Warranty claims information see the "Warranty Claims and Return Policy" form QM1021 available from the [Munters Corporation office at 1-800-227-2376 or by e-mail at aghort.info@munters.com](mailto:aghort.info@munters.com).

### Conditions and Limitations:

- Products and Systems involved in a warranty claim under the "Warranty Claims and Return Policy" shall have been properly installed, maintained and operated under competent supervision, according to the instructions provided by Munters Corporation.
- Malfunction or failure resulting from misuse, abuse, negligence, alteration, accident or lack of proper installation or maintenance shall not be considered a defect under the Warranty.

# Index

Chapters	Page
1. Unpacking the Equipment	4
1.1 Parts List	4
1.2 Inlet Dimensions	4
2. Installation Instructions	5
3. Cabling	12

# Unpacking the Equipment

# 1.

## 1.1 Parts List

Before beginning installation, check the overall condition of the equipment. Remove packing materials, and examine all components for signs of shipping damage. Any shipping damage is the customer's responsibility and should be reported immediately to your freight carrier.

### Each Sidewall Inlet includes:

- 1 - Inlet Frame with Bird Screen
- 2 - Inlet Side Panels
- 1 - Inlet Door
- 2 - Inlet Door Bracket
- 1 - Inlet Directional Flap
- 1 - Hardware Package

### Hardware Package

ID	Qty.	Description
[A]	2	5.3 x 15mm Washer
[B]	3	8.4 x 17mm Washer
[C]	12	M5 x 25mm Pan Head Screw
[D]	2	M6 x 30mm Bolt
[E]	2	M5 x 50mm Raised Head Screw
[F]	3	M5 x 80mm Countersink Screw
[G]	2	115mm Tension Spring
[H]	2	Directional Flap Adjustment Bushing

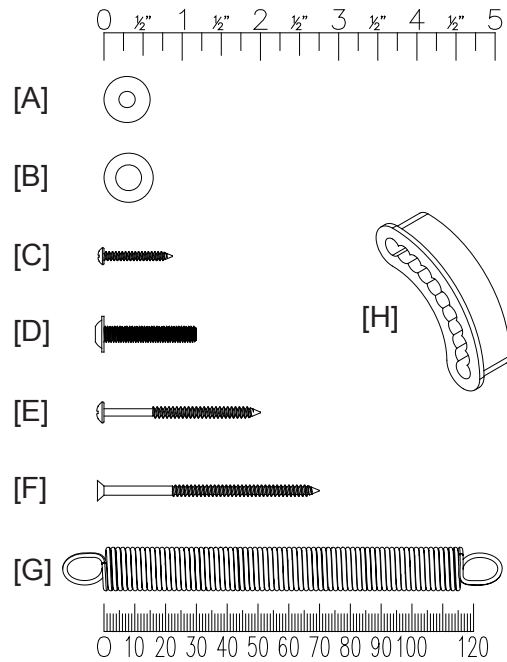

## 1.2 Inlet Dimensions

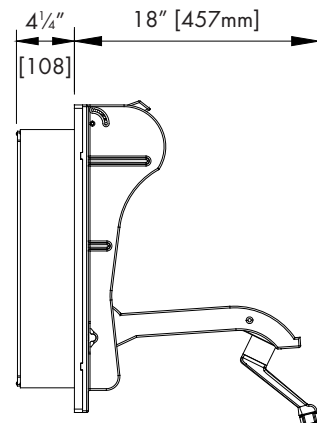
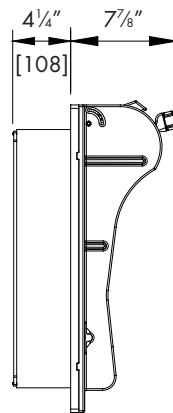
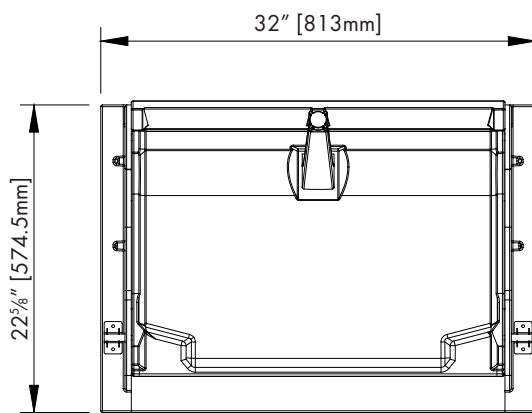

Wall Opening

19 7/8" [505mm] H. x 29 3/8" [746mm] W.

# Installation Instructions

# 2.

## Step 1

Construct a framed opening to correct size according to Wall Opening listed in chart on previous page. A minimum of 10" - 12" from ceiling to the top inside of the stud. See [Figure 1A and 1B](#).

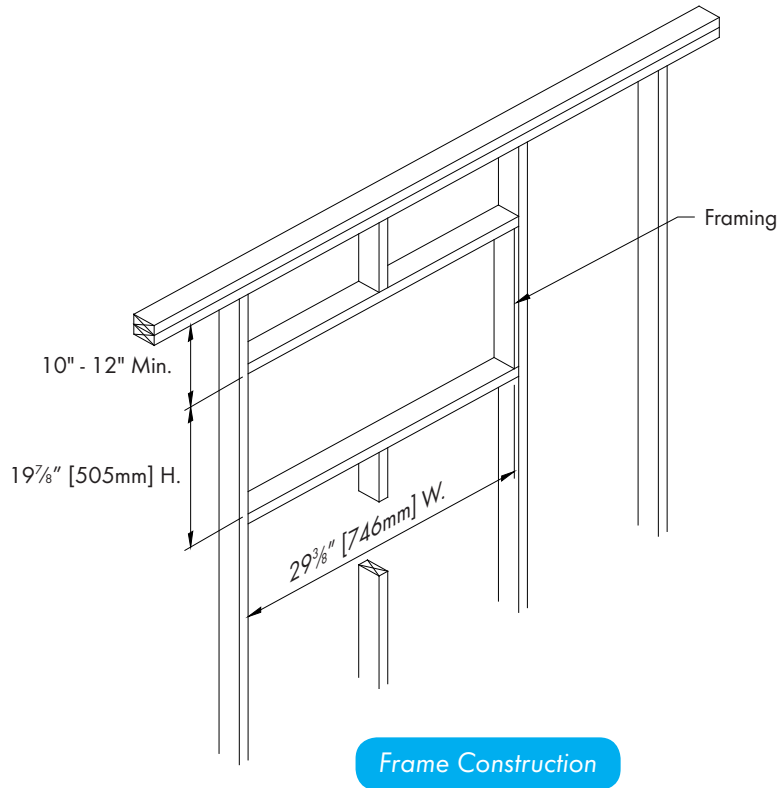

Frame Construction

Figure 1A

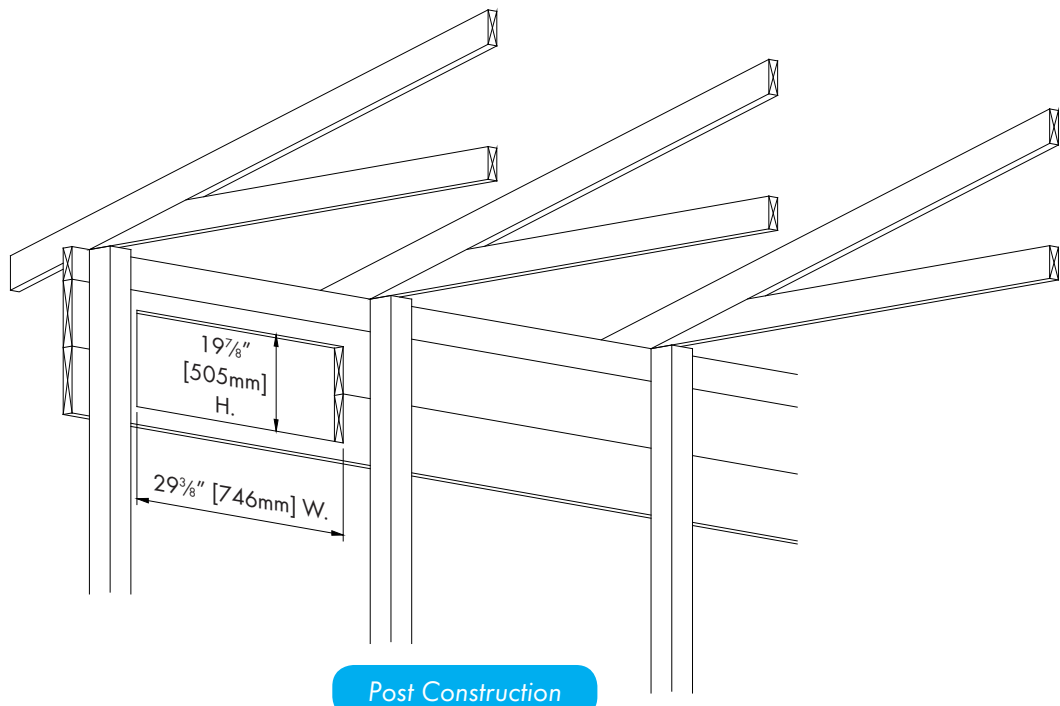

Post Construction

Figure 1B

**Step 2**

Find the Inlet Frame and secure (2) Side Panels to it using (8) Pan Head Screws [C]. Make sure Side Panels are aligned and fully seated to Inlet Frame before securing. See Figure 2.

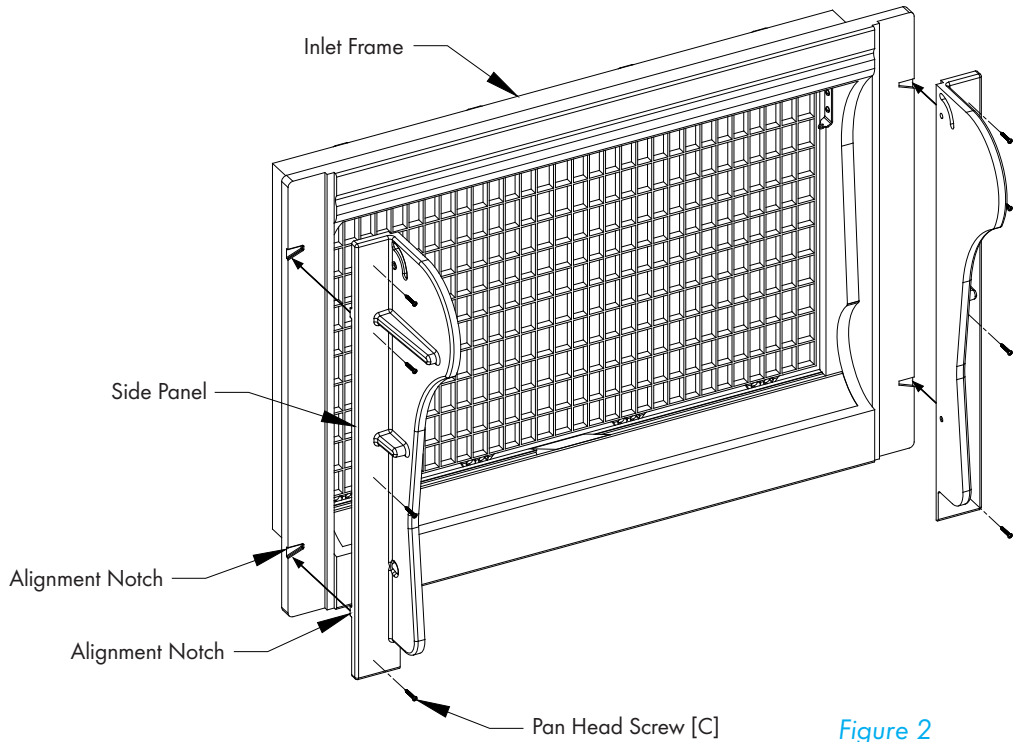

Figure 2

**Step 3**

Slide Inlet Door into Inlet between Side Panels with the wider portion of the door towards the bottom of Inlet. Then slide the Pin of the Door Bracket through Side Panel and into Inlet Door. Repeat for other side.

See Figure 3.

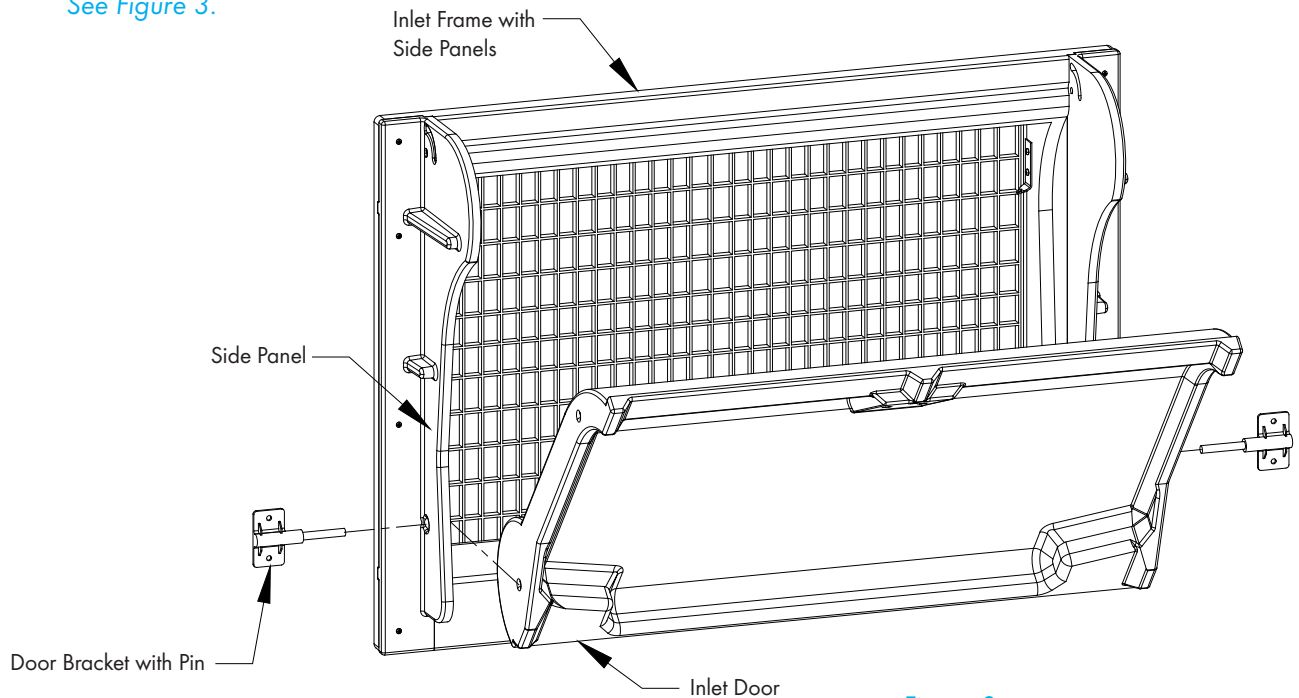

Figure 3

**Step 4**

Make sure Door Bracket is aligned with the edge of inlet and secure in place using (2) Pan Head Screws [C]. Repeat for other side. Make sure door opens and closes freely. See Figures 4.

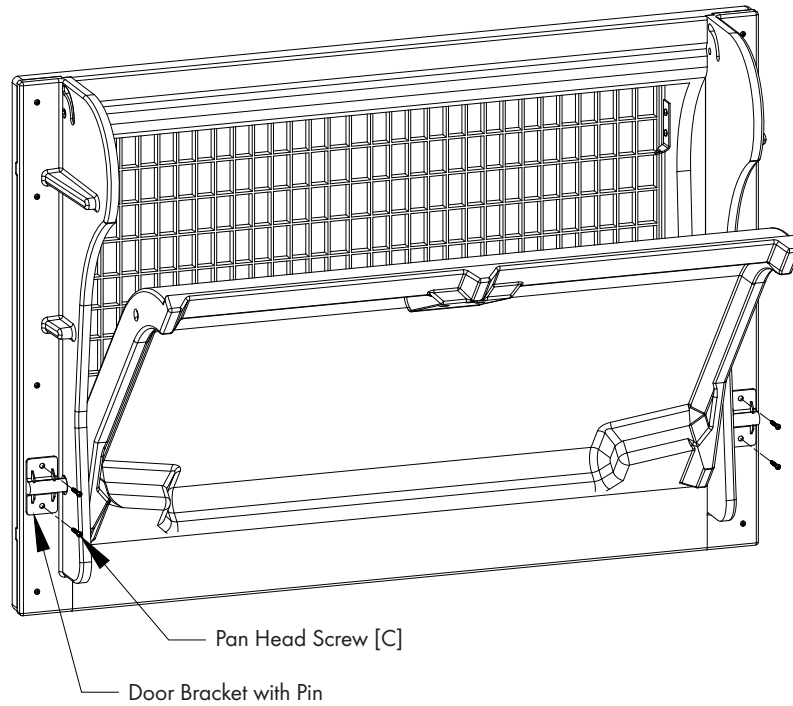

Figure 4

**Step 5**

Slide Directional Flap into Inlet between Side Panels and fasten in place using (2) M6 Bolts [D]. See Figures 5.

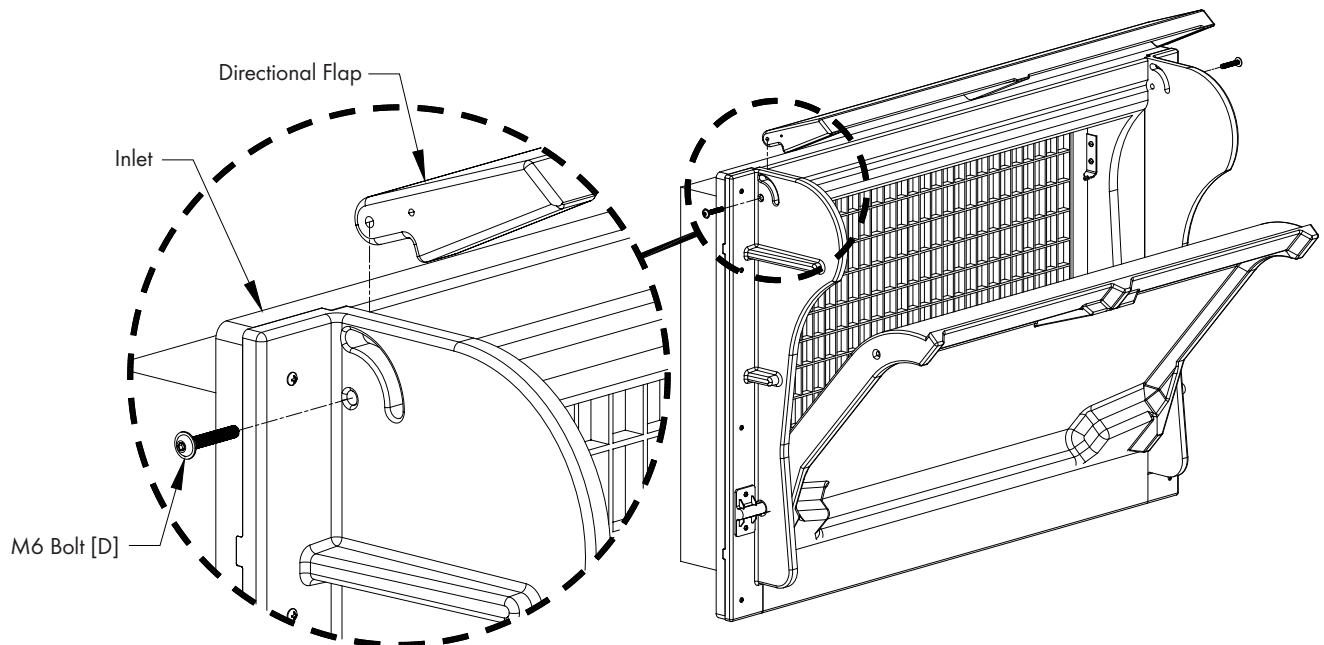

Figure 5

**Step 6**

Insert Directional Flap Bushing [H] into slot in Side Panel. Insert Raised Head Screw [E] through 15mm Washer [A] and Directional Flap Bushing [H] into hole in Directional Flap and tighten to a snug fit. DO NOT over tighten, Directional Flap should be able to adjust to each notch in Bushing. [See Figures 6.](#)

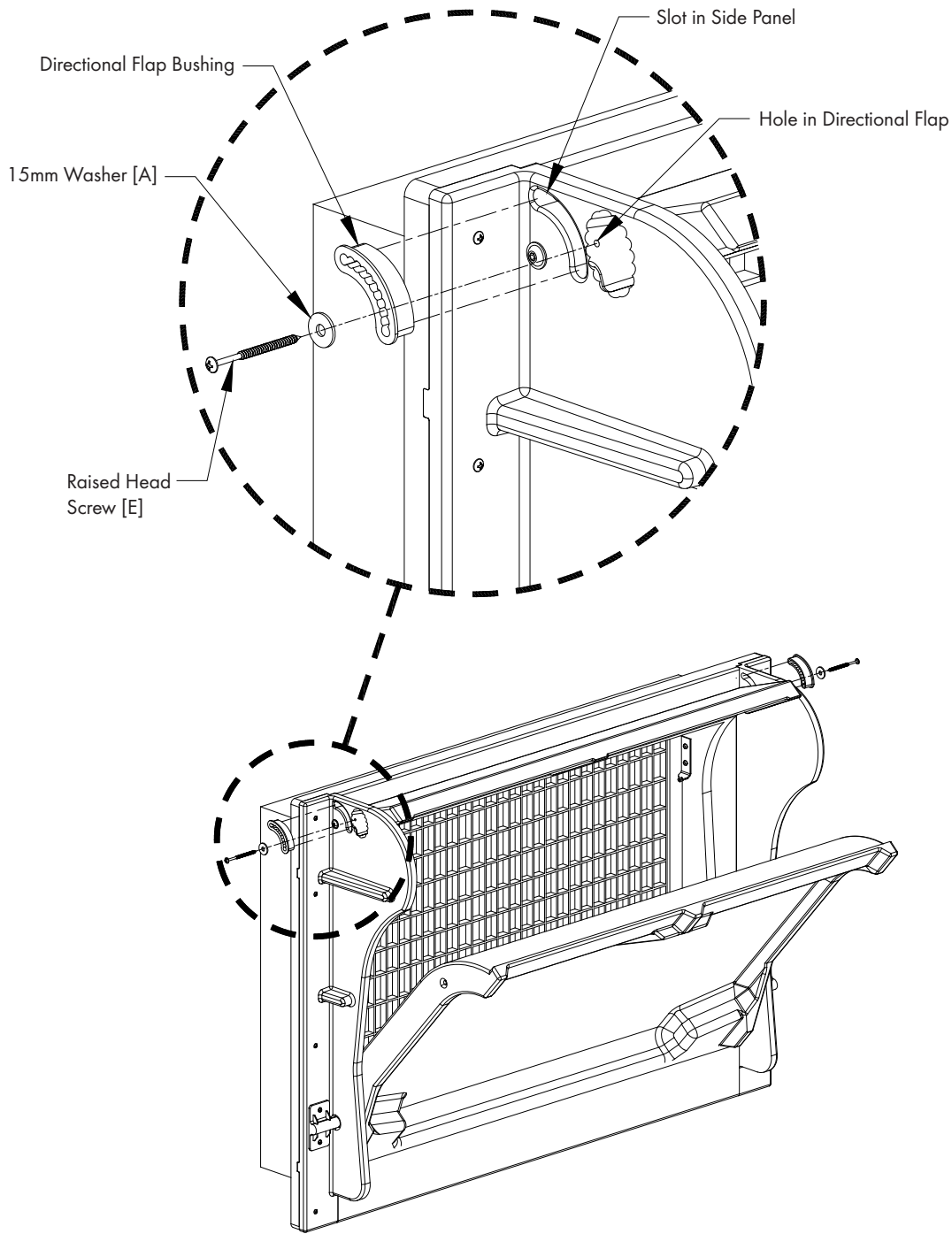

Figure 6



## Step 7

For the AO (Auto Open) Inlet, thread the large Blue Nut onto Lift Arm and press Lift Arm onto Spacer Block. Attach Lift Arm with Spacer Block to Door using (3) Countersink Screw [F] and 17mm Washer [B]. See Figures 7A. For the AC (Auto Close) Inlet, attach Lift Arm to Door using (3) Countersink Screw [F] and 17mm Washer [B]. See Figures 7B.

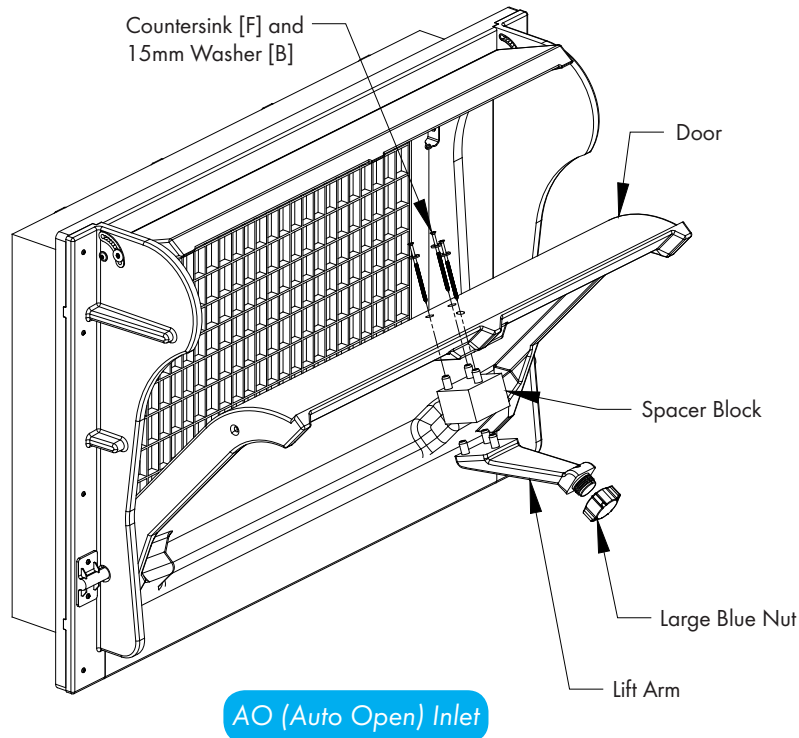

Figure 7A

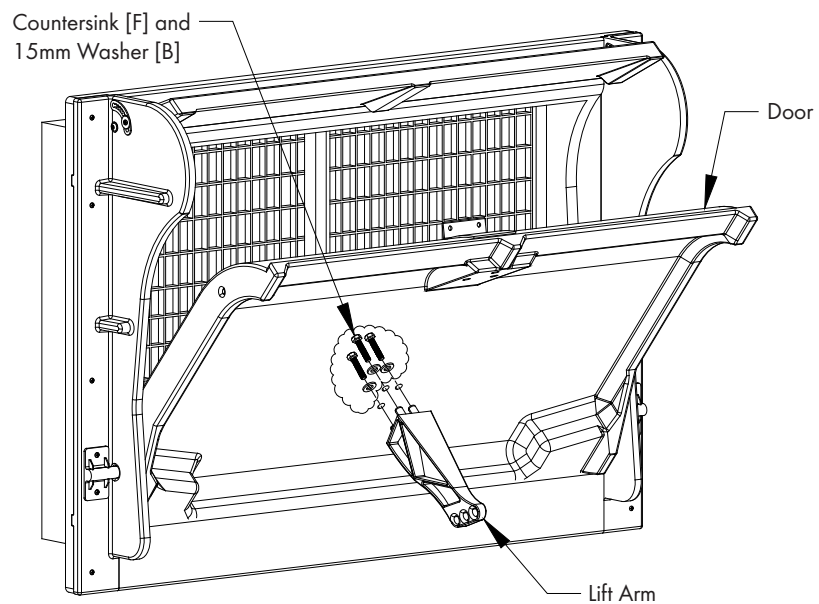
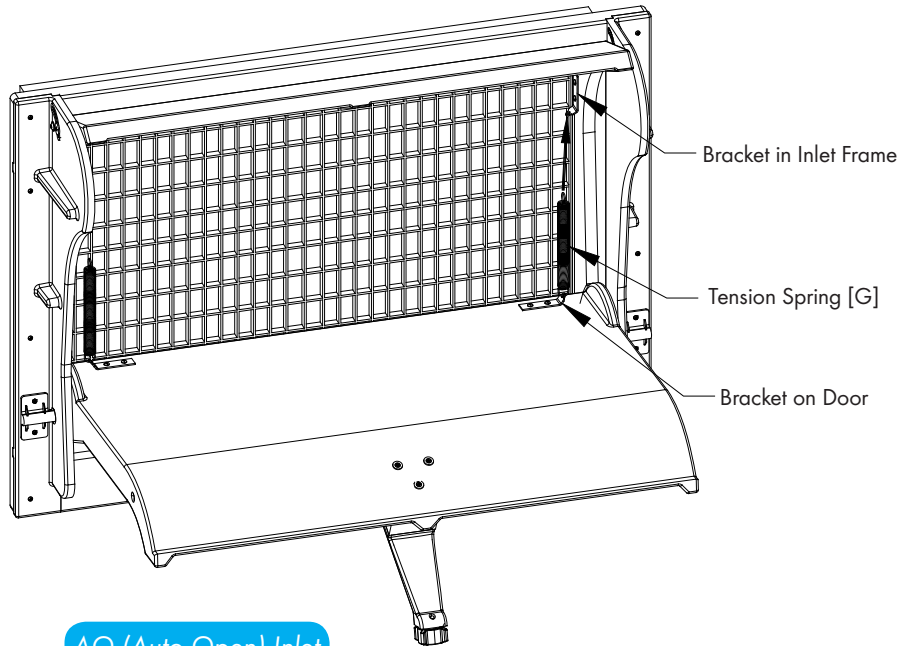

Figure 7B

Step 8

For the AO (Auto Open) Inlet, attach (2) Tension Spring [G] from the brackets on the door to the brackets in the inlet frame. See Figures 8A. For the AC (Auto Close) Inlet, attach (2) Tension Spring [G] from bracket on center support to bracket on inside of door. See Figures 8B.



AO (Auto Open) Inlet

Figure 8A

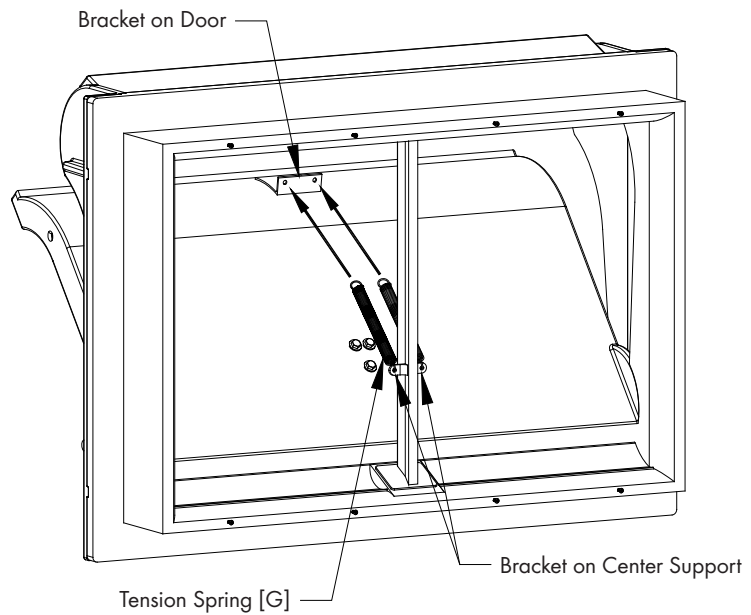

AC (Auto Close) Inlet

Figure 8B

**Step 9**

Apply a bead of caulk to face of framing, then slide inlet into framing. [See Figures 9.](#)

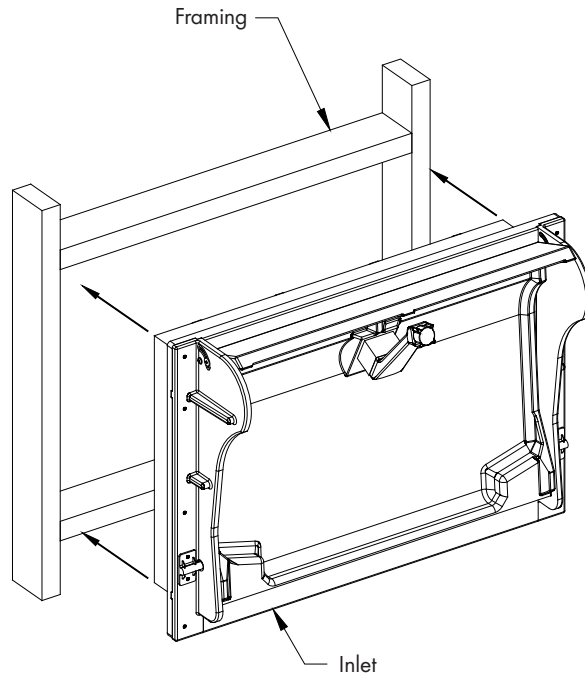

**Figure 9**

**Step 10**

Secure inlet in framing using (6) 2" Pole Barn Screws (not provided). Be sure not to overtighten screws and damage inlet. [See Figures 10.](#)

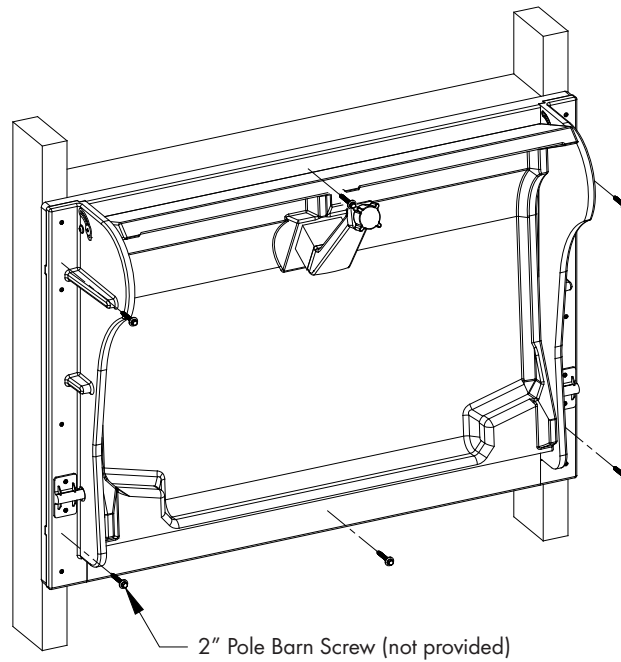

**Figure 10**

## Step 11

Attach pulleys in line with screw hooks at each endwall. See Figure 11A and 11B.

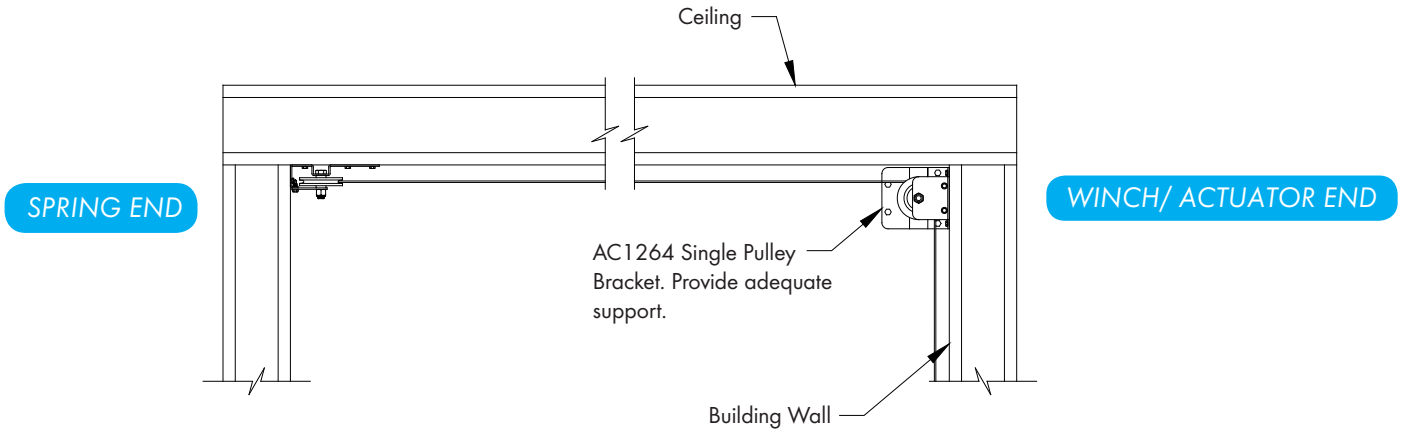

Figure 11A

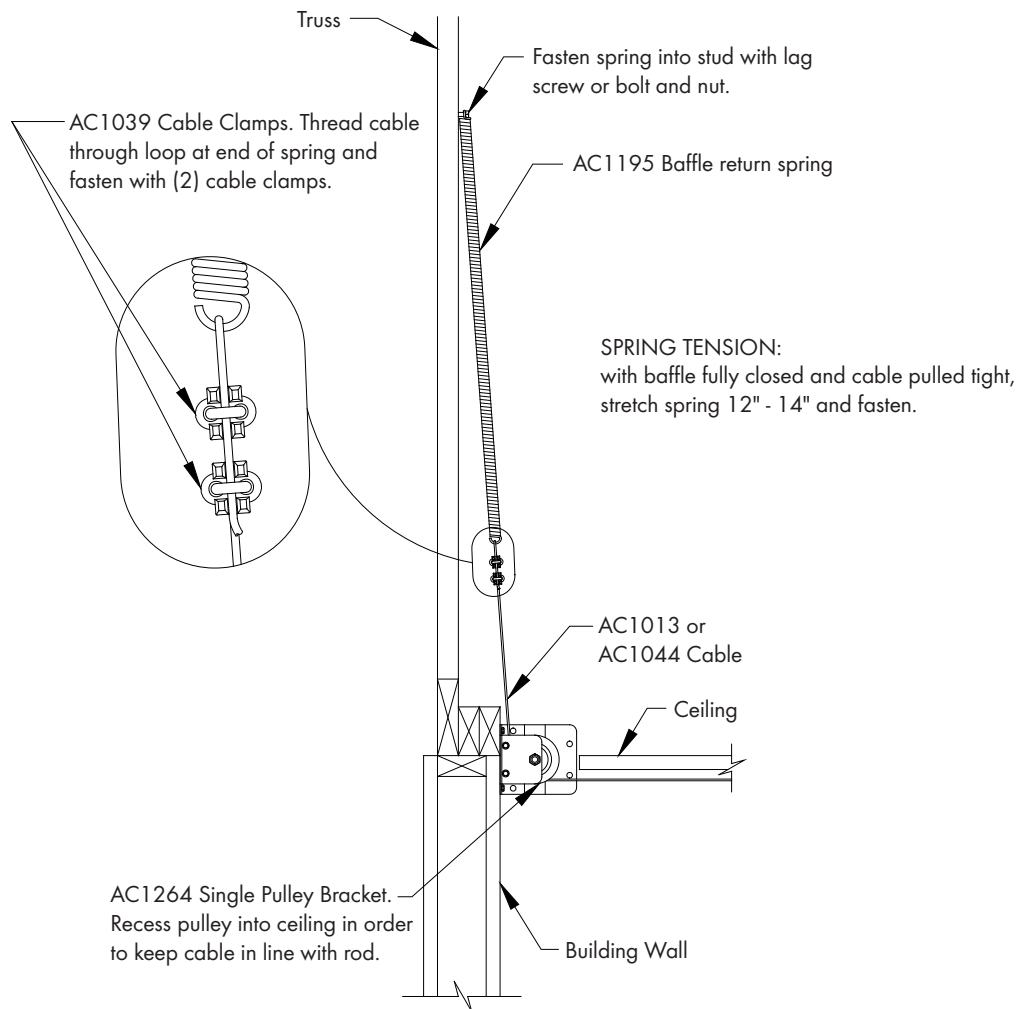

Figure 11B

## Step 12

For the AO (Auto Open) Inlet, install the Wall Guide Bracket  $7\frac{7}{8}$ " [200mm] above the top of the inlet using (3) 2" Pole Barn Screws (not provided). See Figures 12A. For the AC (Auto Close) Inlet install the Wall Guide Bracket 4" [100mm] below the bottom of the inlet using (3) 2" Pole Barn Screws (not provided). See Figures 12B.

See Figures 12B.

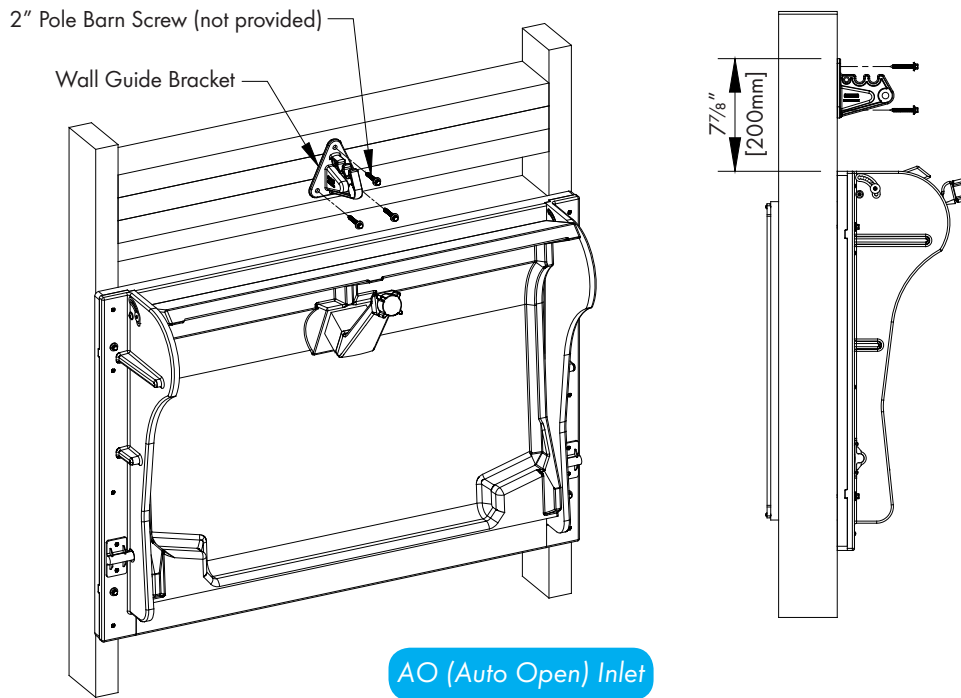

Figure 12A

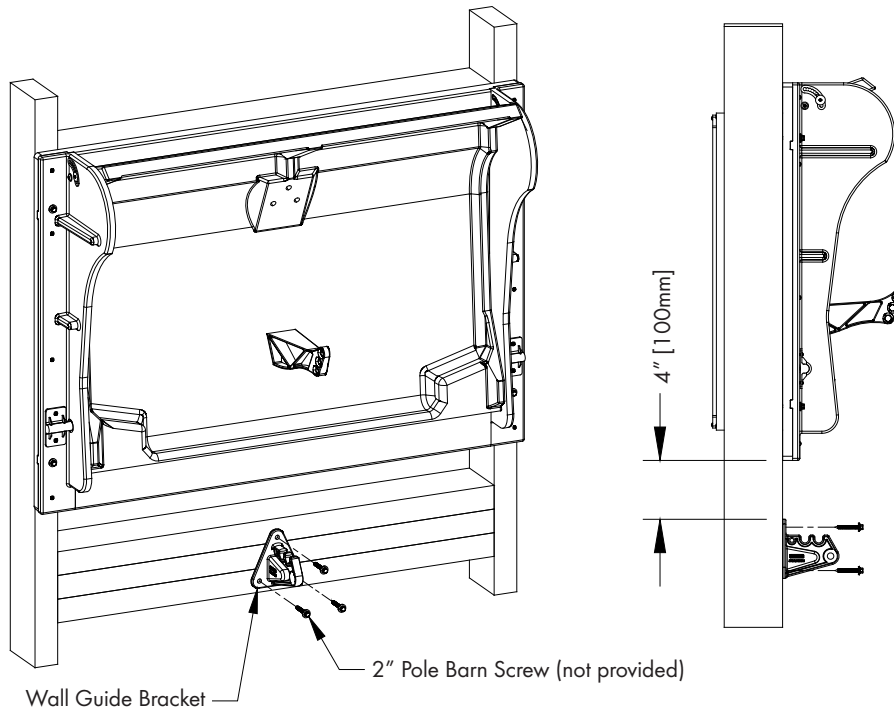
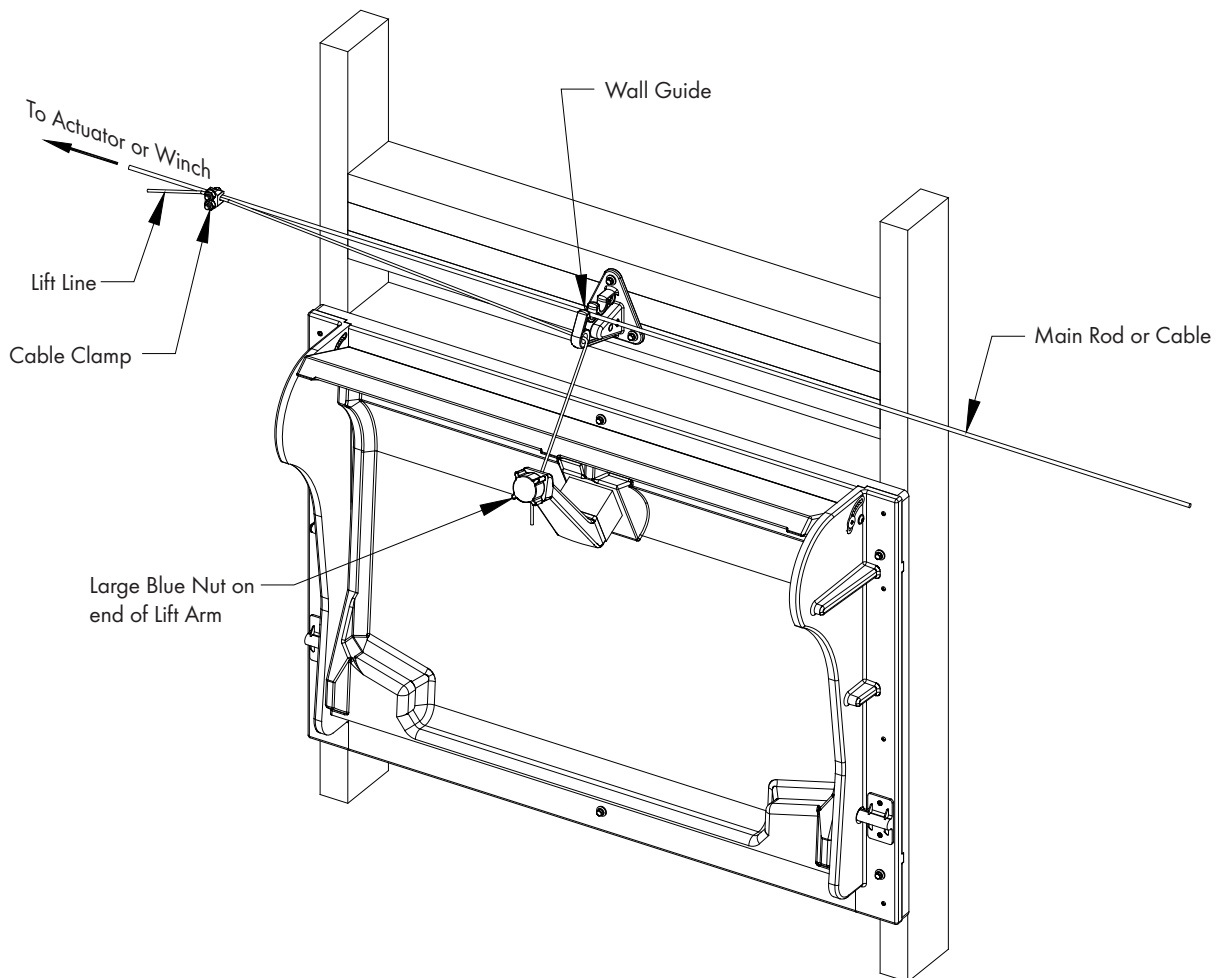

Figure 12B

**Step 13A**

For the AO (Auto Open) Inlet, run Main Rod or Cable in outer groove of Wall Guide. Additional support for Main Rod or Cable may be required. Attach Lift Line to Main Rod/Cable 14" back from Wall Guide toward Actuator using cable clamp. Run lift line through the hole in the end of the Wall Guide and down through the hole in the Lift Arm and secure by tightening the large Blue Nut on end of Lift Arm.

See Figure 13A.



AO (Auto Open) Inlet

Figure 13A

**Step 13B**

For the AC (Auto Close) Inlet, run Main Rod or Cable in outer groove of Wall Guide. Additional support for Main Rod or Cable may be required. Hang supplied Swivel Pulley in outer hole in Lift Arm. Attach Lift Line to Main Rod/Cable 14" back from Wall Guide toward Actuator using cable clamp. Run lift line through the hole in the end of the Wall Guide and up over Swivel Pulley and back down through hole in Wall Guide closest to wall and secure with Azuma Bolt and Nut or similar (not provided). See Figure 13B.

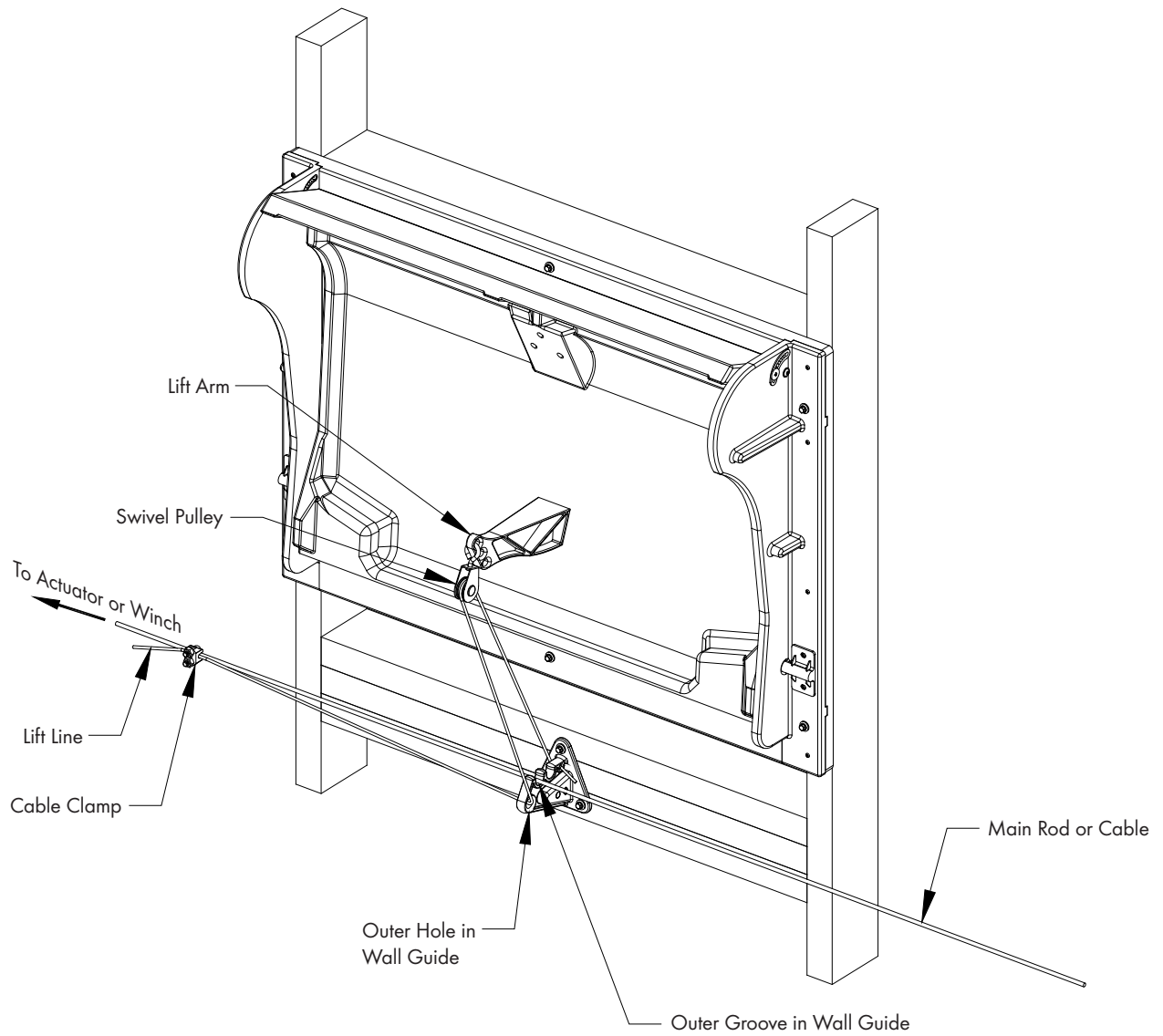

AC (Auto Close) Inlet

Figure 13B

Step 14

With the winch at its fully closed position, go back, check and readjust each baffle door tightly to inlet frame. Use winch or actuator to open and close inlets a few times to make sure inlet moves smoothly and each door remains even over the total length of house. See Figure 14.

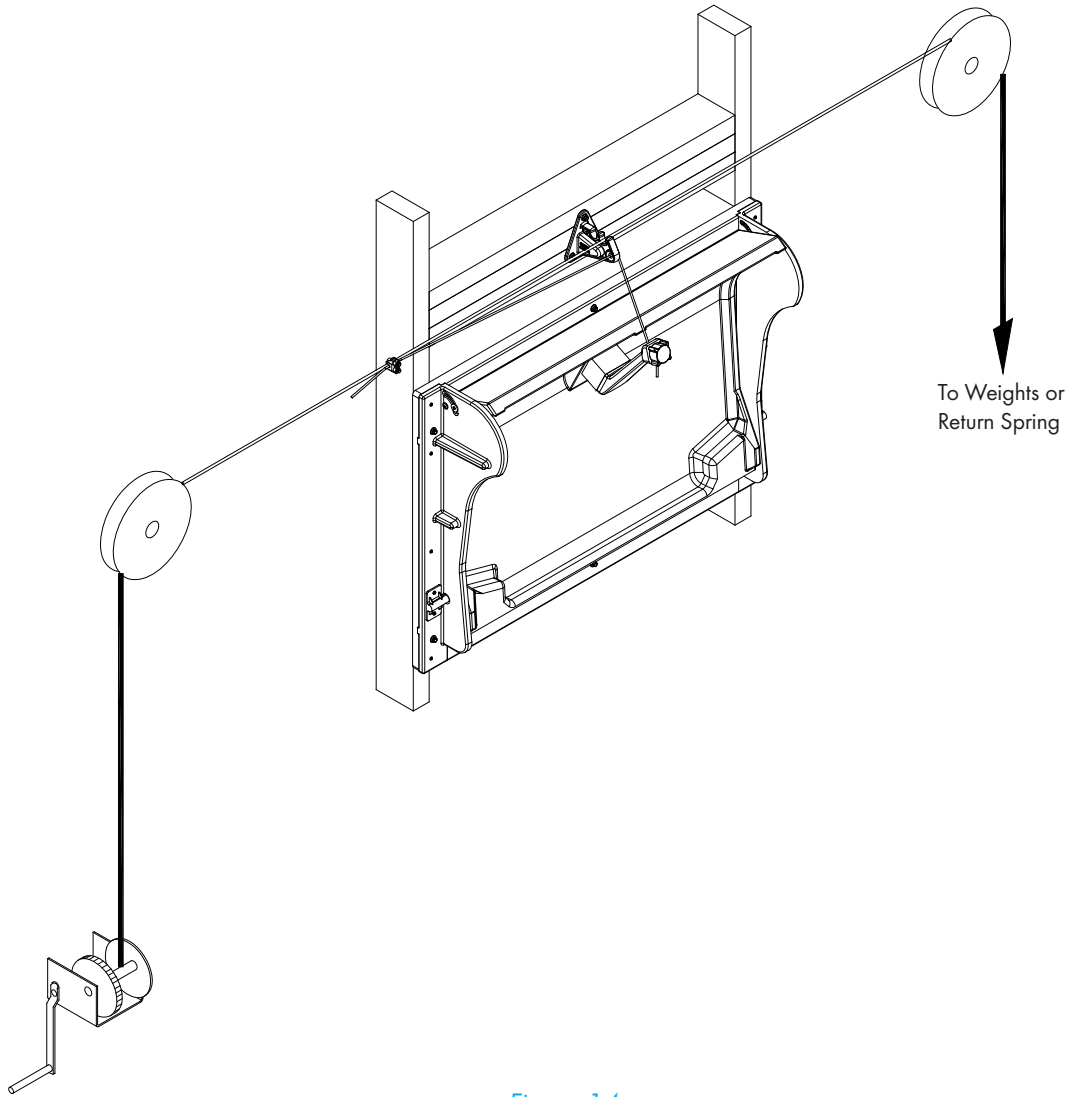

Figure 14



**This page left blank intentionally**

ZEWP2900 Reventa Inlets are Sold by Munters Corporation Lansing, Michigan U.S.A. 1-800-227-2376



Munters Europe AB, Isafjordsgatan 1, P.O. Box 1150, SE-164 26 Kista, Sweden. Phone +46 08 626 63 00, Fax +46 8 754 56 66.

Munters Corporation 2691 Ena Drive Lansing, MI 48917 U.S.A. Phone +1 800-227-2376, Fax +1 517-676-7078

[www.munters.us](http://www.munters.us)

[Australia](#) Munters Pty Limited, Phone +61 2 6025 6422, [Brazil](#) Munters Brasil Industria e Comercio Ltda, Phone +55 41 3317 5050, [Canada/US](#) Munters Corporation Lansing, MI Phone +1 517 676 7070, [China](#) Munters Air Treatment Equipment (Beijing) Co. Ltd, Phone +86 10 80 481 121, [Denmark](#) Munters A/S, Phone +45 9862 3311, [India](#) Munters India, Phone +91 20 3052 2520, [Indonesia](#) Munters, Phone +62 818 739 235, [Italy](#) Munters Italy S.p.A., Chiusavecchia, Phone +39 0183 52 11, [Japan](#) Munters K.K., Phone +81 3 5970 0021, [Korea](#) Munters Korea Co. Ltd., Phone +82 2 761 8701, [Mexico](#) Munters Mexico, Phone +52 818 262 54 00, [Russia](#) Munters AB, Phone +7 812 448 5740, [Singapore](#) Munters Pte Ltd., Phone +65 744 6828, [South Africa and Sub-Sahara Countries](#) Munters (Pty) Ltd., Phone +27 11 997 2000, [Spain](#) Munters Spain S.A., Phone +34 91 640 09 02, [Sweden](#) Munters AB, Phone +46 8 626 63 00, [Thailand](#) Munters Co. Ltd., Phone +66 2 642 2670, [Turkey](#) Munters Form Endüstri Sistemleri A.Ş, Phone +90 322 231 1338, [USA](#) Munters Corporation Lansing, MI Phone +1 517 676 7070, [Vietnam](#) Munters Vietnam, Phone +84 8 3825 6838, [Export & Other countries](#) Munters Italy S.p.A., Chiusavecchia Phone +39 0183 52 11